

ProGuard™ Defender

Models: DXB Mini, DXB Mini ca



Owner's Manual



Read all instructions carefully in user manual before operating air purifier.

About DXB Mini

This unit is designed to be permanently mounted to a wall surface in several different applications. DXB Mini is ideal for purifying small rooms up to 250 sq. ft. DXB Mini is perfect for use as a wall mounted air purifier in large rooms, small offices, or similar spaces without ductwork that already provides air purification. DXB Mini reduces odors to create a fresh, clean environment.

DXB Mini utilizes Active Radiant Catalysis (ARC®) technology that generates advanced oxidation products (AOP's), primarily consisting of hydro-peroxides, or vaporized hydrogen peroxide. Active Radiant Catalysis purification process use ultraviolet energy to activate a multi-metal catalyst, which converts water vapor into oxidizers including peroxide and hydroxyls. In addition to the ARC process, Bipolar Ionization is used to assist in neutralizing pollutants and odors.

Table of Contents

| | |
|--------------------------------|----|
| Specifications | 3 |
| Warnings | 3 |
| Unit Diagrams | 4 |
| Installation | 5 |
| Cleaning the Unit | 6 |
| Filter Replacement | 6 |
| ARC Cell Replacement | 7 |
| BPI Module Replacement | 8 |
| Replacement Part Numbers | 9 |
| Cell Disposal | 9 |
| Troubleshooting | 10 |
| Warranty Information | 11 |

Specifications

| | |
|-----------------------|---|
| Models | DXB Mini (1X5800) |
| | DXB Mini ca (1X5788) |
| Dimensions | 11.92" H (303mm) x 9.72" W (247mm) x 3.64" D (93mm) |
| Weight | 3.3 lb (1.5kg) |
| Supply | 120/240VAC / 17W |
| Operation | 24VDC / .67A |
| Effective Area* | Up to 250 ft ² |
| Warranty | 2 Years |

*Depending on variables such as the severity and frequency of pollution, flow of air in the environment, humidity, and temperature.

Warnings

Please read and follow all warnings and cautions before installing and using your Defender DXB.



Use this unit only in a manner intended by the manufacturer.
If you have questions, contact the manufacturer.



Never insert hands into the unit's fan motor
while it is plugged in or running.



Avoid looking directly at the UV lamps in the
ARC® (Active Radiant Catalysis) Cell.



Follow all installation instructions.



Before servicing or cleaning the unit, unplug from its power source.



Replace filter every 3-4 months to avoid damaging your unit.

Unit Diagrams

Unit Front

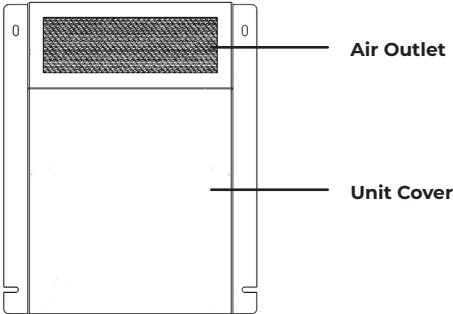

Unit Rear

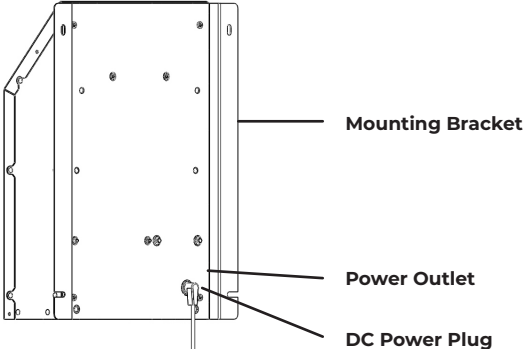

Unit Bottom

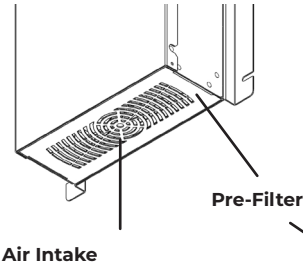

Unit Internals

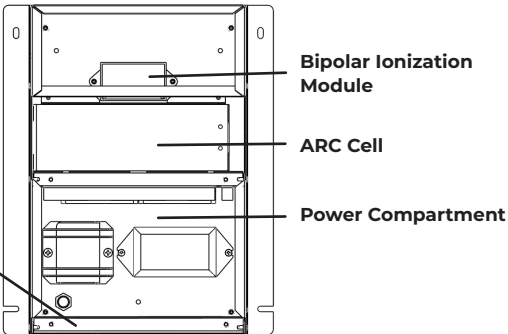

Installation

1. Determine location for desired placement of unit close enough to a power outlet to allow the included 120/240 VAC to 24 VDC power adapter to be plugged in. Typically, the angled grille should be pointed upward and mounted as high on the wall as practical, within 18 inches of the ceiling if possible.

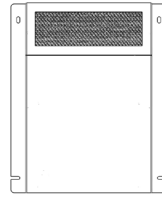

STEP 1



2. Plug the power adapter's elbow style DC connector into the unit's rear power outlet.
3. Attach the DXB Mini to the wall location with the included screws utilizing the mounting bracket flanges.

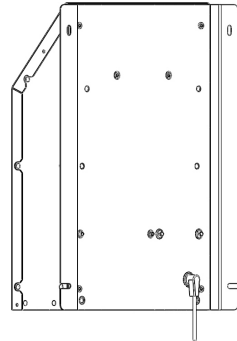

STEP 2

4. Make proper electrical connection of 24VDC power adapter to outlet.

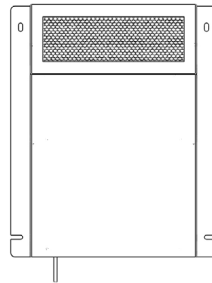

STEP 3

Cleaning the Unit

The unit will need to be cleaned inside from time to time as well. Be sure to use extreme caution when doing this in order to avoid any damage to the unit or harm to yourself.



WARNING: Make sure to disconnect the unit from its power source before any maintenance or cleaning is done.

1. Disconnect unit from power source.
2. Remove the Cover's two screws along the top edge using a T-10 security screw driver.
3. Tilt the Cover away from the top of the unit.
4. Wipe everything down with a damp cloth.
5. Close and secure the Cover of the unit.
6. Reconnect unit to power source.

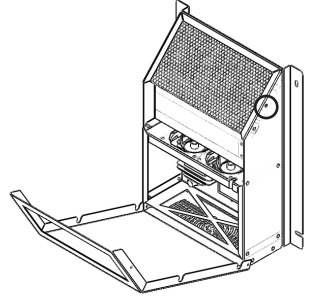

Filter Replacement

See Page 9 for Replacement Part Numbers.



WARNING: Make sure to disconnect the unit from its power source before any maintenance or cleaning is done.

We recommend replacing the Filter every 3-4 months or when noticeably contaminated.

1. Disconnect unit from power source.
2. Remove the Cover's two screws along the top edge using a T-10 security screw driver.
3. Tilt the Cover away from the top of the unit.
4. Replace the used Filter at the bottom with the red side out.
5. Close and secure the Cover of the unit.
6. Reconnect unit to power source.

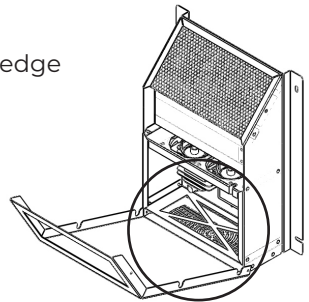

ARC® Cell Replacement

See Page 9 for Replacement Part Numbers.



WARNING: Make sure to disconnect the unit from its power source before any maintenance or cleaning is done.



WARNING: Please do not throw a used ARC® Cell in the garbage. See CELL DISPOSAL (PG. 9) for disposal instructions

Your ARC Cell should be replaced every year.

1. Disconnect unit from power source.
2. Remove the Cover's two screws along the top edge using a T-10 security screw driver.
3. Tilt the Cover away from the top of the unit.
4. Remove the Black Grille by sliding it down and out.
5. Locate the ARC Cell and gently lift it up out of the case.
6. Disconnect the power to your old ARC Cell and replace it with your new ARC Cell. Ensure plug is fully seated in the connection and the wire is fully seated into the grommet/ bulkhead.
7. Place the ARC Cell in place in the unit with the warning label visible, making sure air can flow through the cell.
8. Replace the Black Grille.
9. Close and secure the Cover of the unit.
10. Reconnect unit to power source.

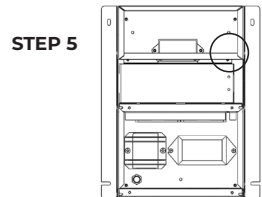
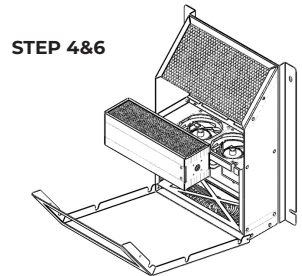
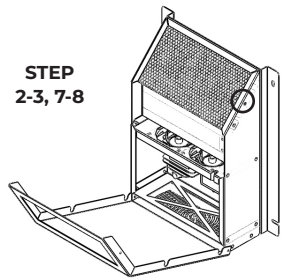

BPI Module Replacement

See Page 9 for Replacement Part Numbers.



WARNING: Make sure to disconnect the unit from its power source before any maintenance or cleaning is done.

Your BPI Module should be replaced every year.

1. Disconnect unit from power source.
2. Remove the Cover's two screws along the top edge using a T-10 security screw driver.
3. Tilt the Cover away from the top of the unit.
4. Remove the Black Grille by sliding it down and out.
5. Remove screws securing the BPI Module to the unit.
6. Cut Black and White Wire Leads from BPI Module 1" from Module and strip insulation ½" on leads left in unit.
7. Mount the replacement BPI Module with the brushes closest to the ARC Cell and secure with screws.
8. Cut Black and White Wire Leads from BPI Module leaving at least 2" of length from Module.
9. Strip wire lead's insulation from BPI Module ½" and then connect with power leads in unit using included wire lever connectors. Be sure to match white to white and black to black when connecting the wires.
10. Replace the Black Grille.
11. Close and secure the Cover of the Unit.
12. Reconnect unit to power source.

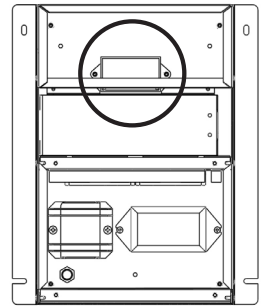
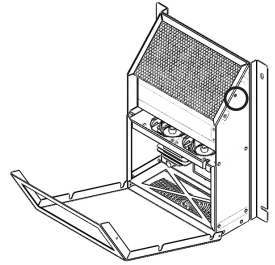

Replacements Part Numbers

Please reference these part name and numbers when contacting your dealer or Innovative Solutions for replacement parts.

| | |
|---|----------------|
| DXB Mini Replacement ARC® Cell | 1X5590 |
| DXB Mini ca Replacement ARC® Cell | 1X5115 |
| DXB Mini Replacement Filter (Both Models) - 6 Pack | 1X5645DXB Mini |
| Replacement BPI Module (Both Models) | 1X5787 |

Cell Disposal (Hg - LAMP CONTAINS MERCURY)

Please do not throw a used ARC® Cell in the garbage. The special UVC bulb used in the unit contains a very small amount of mercury. Manage in accordance with disposal laws.

(Visit www.lamprecycle.org for proper instructions.)

Dispose of the spent ARC Cell and UV Lamp at your local recycling center or by local regulations.

Troubleshooting

ARC® Cell Doesn't Turn On

- Check for secure electrical connections
- Try another ARC® Cell
- Ballast needs replaced (Visit www.Innovative-Solutions.org for contact information)

Fan Doesn't Turn On

- Check for secure electrical connections
- Fan needs replaced (Visit www.Innovative-Solutions.org for contact information)

Warranty Information

Your DXB Mini and/or DXB Mini ca (Product) and genuine ProGuard parts are warranted to be free from all defects in material and workmanship in normal use for a period of two (2) years from date of purchase.

The warranty is granted only to the original purchaser. The warranty is subject to the following provisions:

Any damages or malfunctions caused by negligence, abuse, or use not in accordance with the Product Owner's Manual are not covered by this warranty. Likewise, any defects or damages caused by unauthorized service or the use of other than Genuine Innovative Solutions Parts are not covered.

Innovative Solutions will, at its option, repair or replace a defective Product or part(s) for the Product that is/are covered by this warranty. As a matter of warranty policy, Innovative Solutions will not refund the customer's purchase price.

OBTAINING WARRANTY SERVICE

To obtain warranty service you must return the defective product along with proof of purchase to the Innovative Solutions Authorized Service Center. All shipping costs submitted under this Warranty shall be borne by purchaser. Unless this Warranty is expressly renewed or extended by Innovative Solutions, any repaired or replaced part of unit shall be warranted to the original purchaser only for the length of the unexpired portion of the original warranty. For the location of the nearest Innovative Solutions Authorized Service Center or for other service information, please visit us online at:

www.Innovative-Solutions.org/contact

Before any product is sent for service, the customer should contact the Innovative Solutions Service Center to obtain a Return Merchandise Authorization (RMA) Number. This RMA Number should be clearly written on the box before shipping. All components/parts including the remote (if applicable), manuals, and original packaging should be included in the return if available.

FURTHER LIMITATIONS AND EXCLUSIONS ARE AS FOLLOWS

Any warranty that may be implied in connection with your purchase or use of the Product, including any warranty of merchantability or any warranty for Fitness For A Particular Purpose is limited to the duration of this warranty. Some states do not allow limitations on how long an implied warranty lasts, so the above limitations may not apply to you.

Your relief for the breach of this warranty is limited to the relief expressly provided above. In no event shall Innovative Solutions be liable for any consequential or incidental damages loss of profit, or medical expenses caused by any misuse, abuse, accident, negligence, or failure to follow instructions. The company will not be responsible for any written or oral statements made that are inconsistent with this written warranty, or which are misleading or inconsistent with the facts as published by the company in the literature or specifications. Some states do not allow the exclusion or limitation of incidental or consequential damages, so the above limitation or exclusion may not apply to you. This Warranty gives you specific legal rights, and you may also have other rights which vary from state to state.



www.Innovative-Solutions.org